

Mounting Instructions LANCOM Wall Mount (LN)

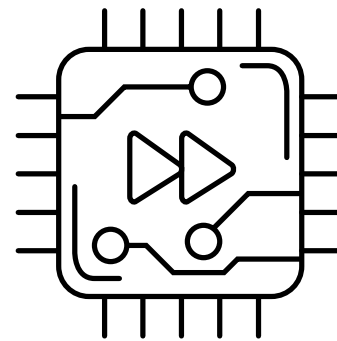

General notes

The LANCOM Wall Mount (LN) is intended exclusively for mounting an access point in a vertical wall or horizontal ceiling installation.

The bracket must be mounted on a solid, non-bendable / non-stretchable surface.

Mounting on (roof) slopes or corrugated roofs, as well as installation in other mounting directions or angles is not permitted or recommended without additional securing of the access point to the bracket.

The mounting is done by four screws in the bracket corners.

Preparing the Wall Mount (LN) for wall mounting

For wall mounting, the bracket must be aligned so that the latching spring ① is at the top.

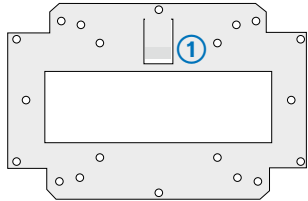

Preparing the Wall Mount (LN) for ceiling mounting

Basically, the access point in ceiling mounting should be secured with at least one Kensington lock and/or LANCOM lock and a padlock.

When mounting on a flat ceiling, use only the four outer holes ②.

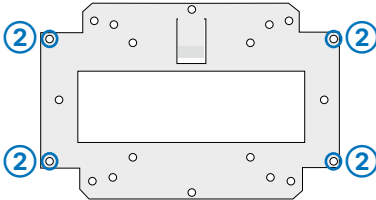

When mounting with T-bar clips (e.g. on suspended ceilings), make sure that only the two outer holes ③ are used for mounting.

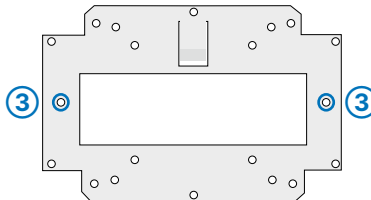

Mounting the Wall Mount (LN)

Use the Wall Mount (LN) as a drilling template. Select the appropriate mounting holes ② or ③ depending on the mounting type and location. When aligning the Wall Mount (LN), guide the cables upwards out of the Access Point housing.

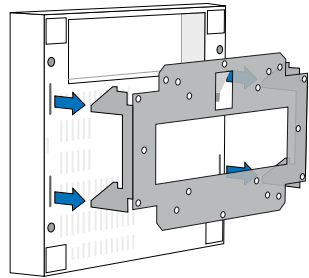
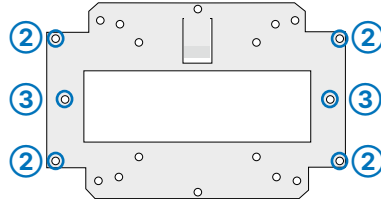

Attaching the access point

Push the access point onto the Wall Mount (LN) as far as it will go, as shown in the illustration. Then press the access point down until it audibly clicks into place.

Securing the access point

Protect the access point against theft using the enclosed lock and padlock.

As the illustration shows, insert the locking device into one of the holes provided when open. Connect the housing and Wall Mount (LN) by pressing both halves of the lock together. Make sure that both holes of the lock are aligned.

Finally, secure the lock with the enclosed padlock.

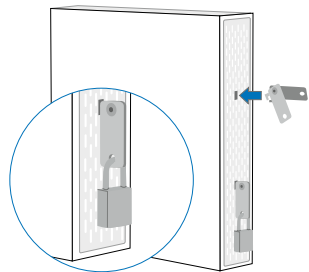

Removing the access point

To detach the device from the Wall Mount (LN), please remove the padlock and lock first. To do this, carry out the previous steps in reverse order.

Release the lock using a tool (e.g. screwdriver). Push the tool in the direction of the wall and hold it in this position. Disconnect the Wall Mount (LN) by first pushing the access point upwards and then pulling it off towards the front.

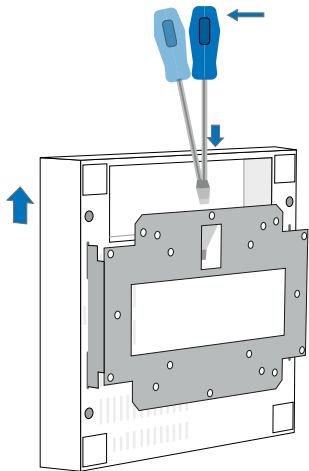

Scope of delivery

| | |
|------------------------|---|
| LANCOM Wall Mount (LN) | Mounting bracket for LANCOM access points of the LN and LX series |
| Theft protection | Lock and padlock |
| Mounting materials | 4x dowels S6, 4x button head screws 4.5×40 |
| Documentation | Mounting instructions LANCOM Wall Mount (LN) |