

H583 - ADA Camera Mount for Huddly GO & Huddly IQ

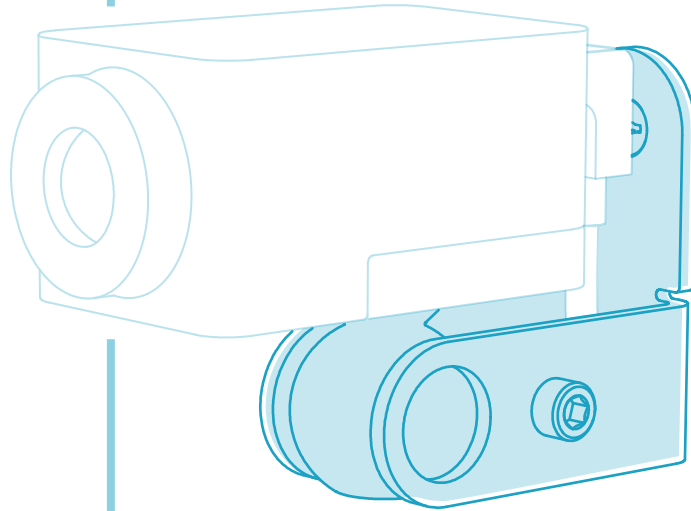

IN THE BOX

- A** 1x ADA Camera Mount
- B** 1x Wall Anchor
- C** 1x Hex Key, 5/32"
- D** 1x Mounting Screw

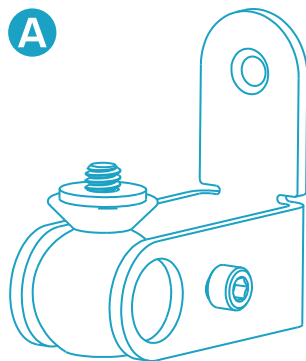

B



C



D



TOOLS NEEDED



Tape Measure



Pen



Power Drill



Phillips
head Bit



1/2" Spade
Drill Bit

COMPONENTS NEEDED (Not Included)

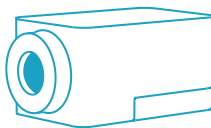

Huddly GO & Huddly IQ

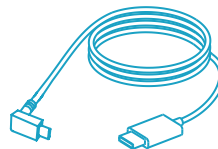

2m USB 3.0 Huddle Room/
Desktop Cable

If you have any questions, please contact
service@hecklerdesign.com.

STEP 1

Locate mounting position

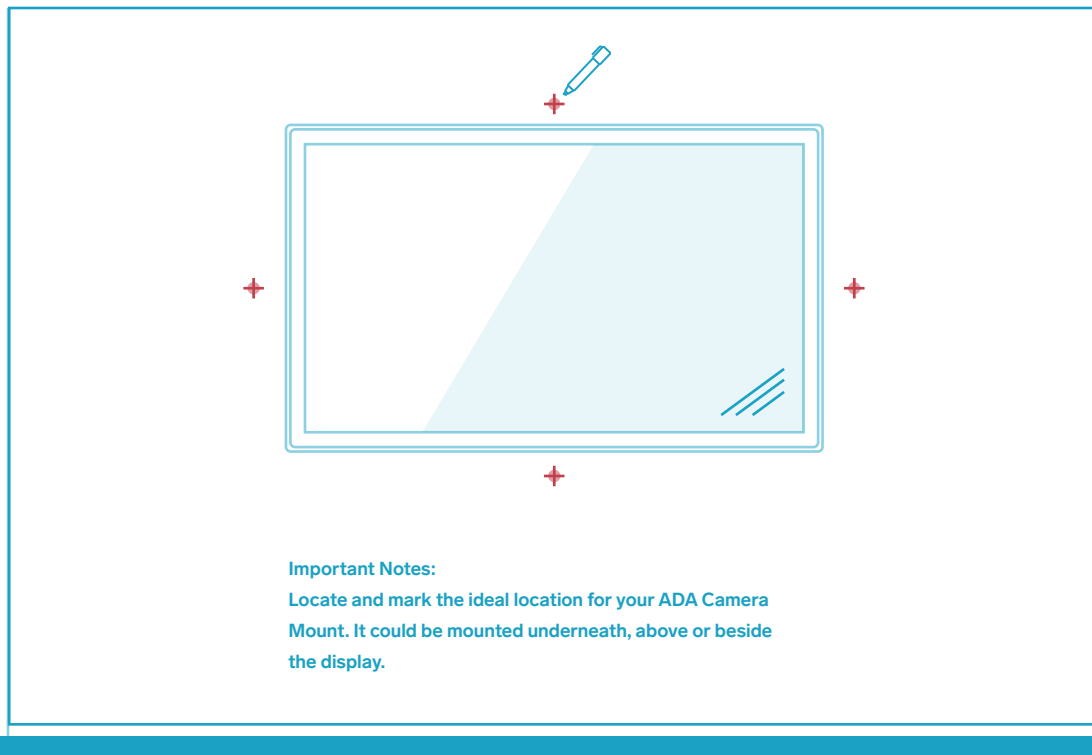

STEP 2

Install the wall anchor

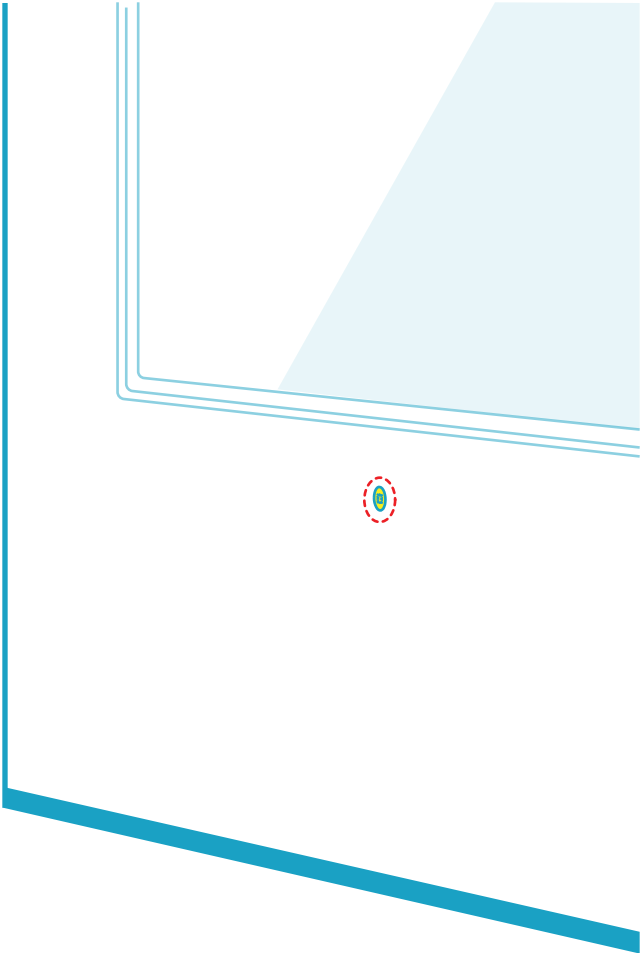
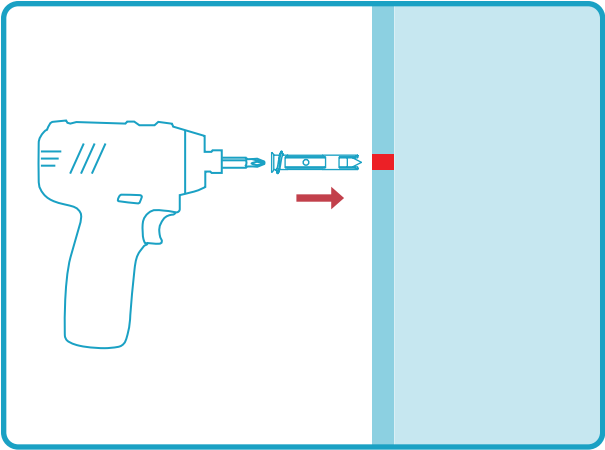

Optional

Mark and drill the hole



Important:

Drill a 1/2-inch hole for the cable to pass through the wall.

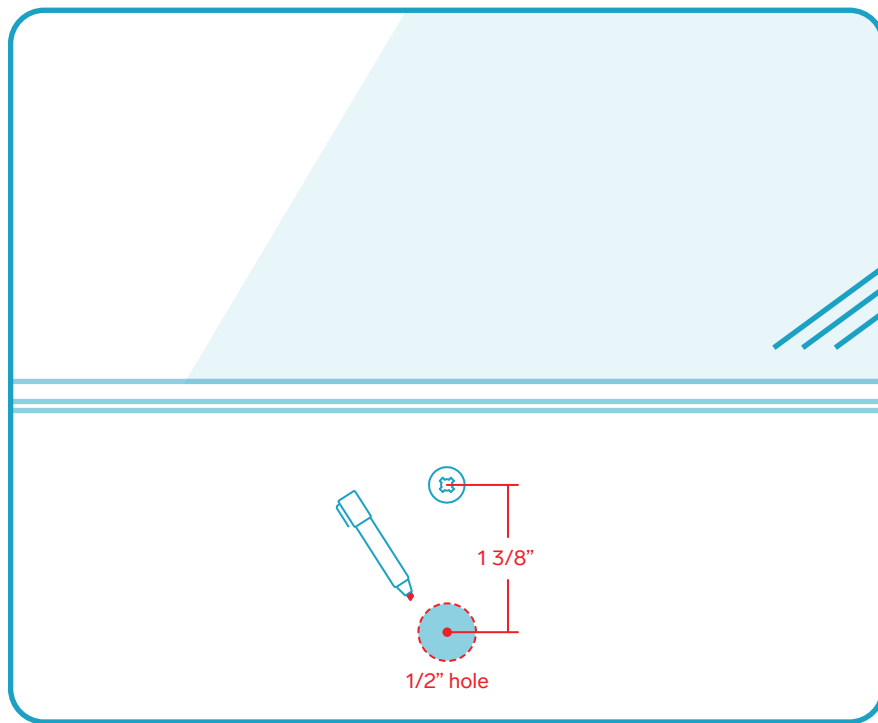

Optional

Route the USB-C cable through the wall

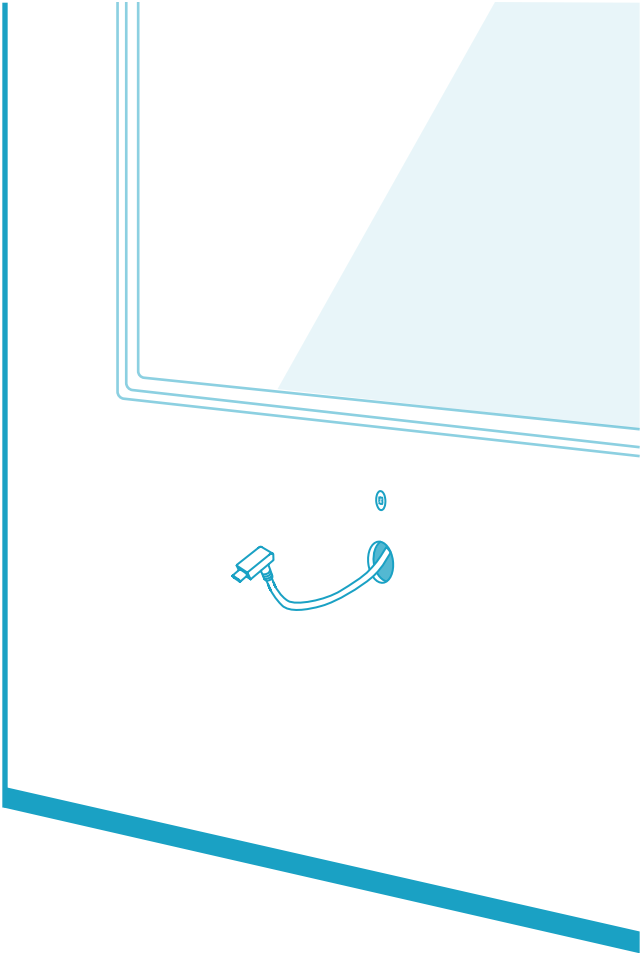
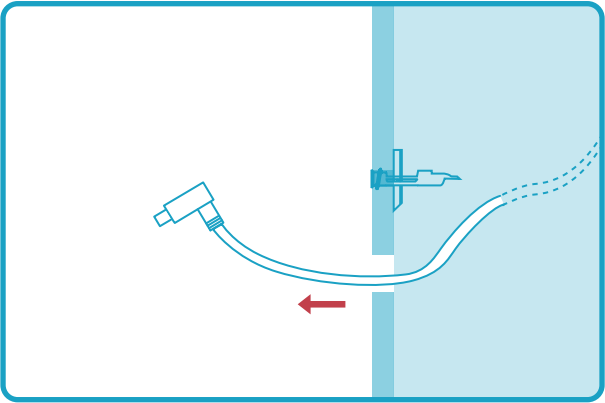

STEP 3

Fasten the ADA Camera Mount

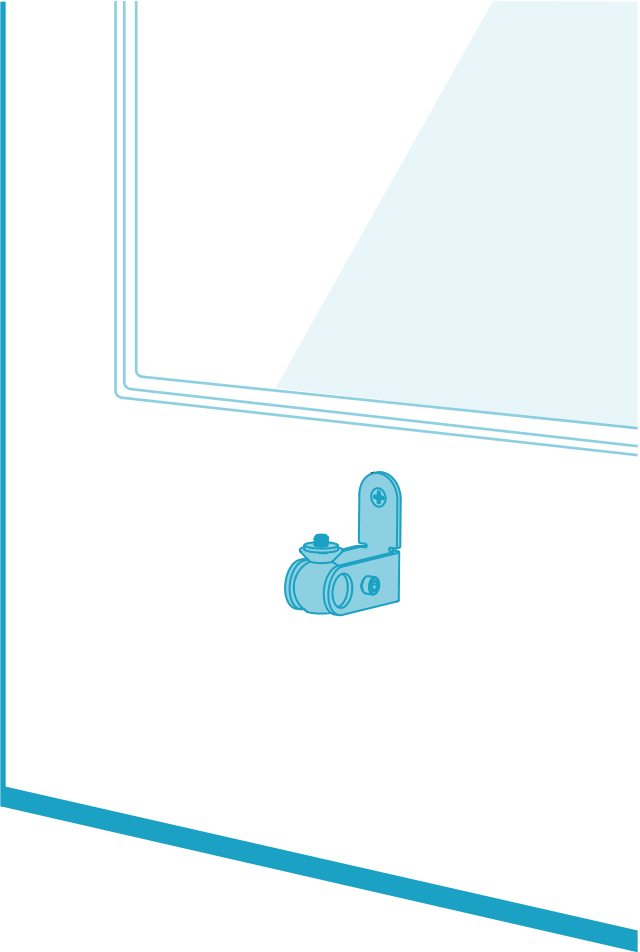
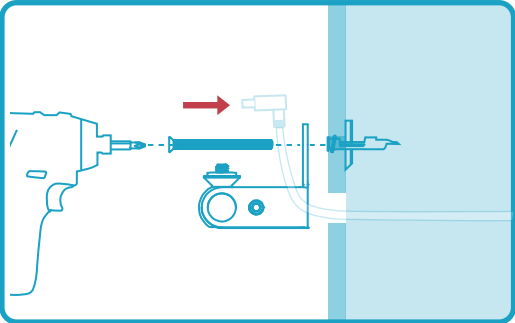

STEP 4

Install the Huddly GO or Huddly IQ

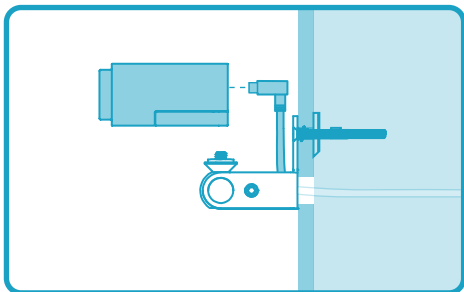

1. Connect the USB-C cable to Huddly GO or Huddly IQ Camera.

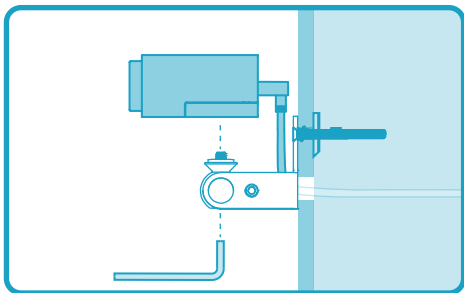

2. Fasten the camera to the ADA Camera Mount with the hex key.

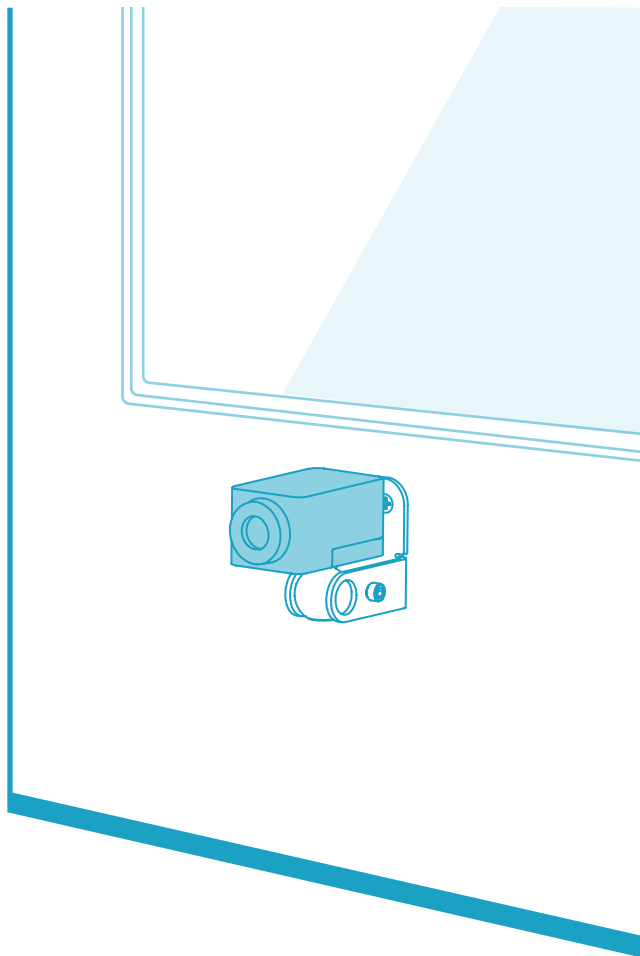

STEP 5

Adjust and set camera orientation.

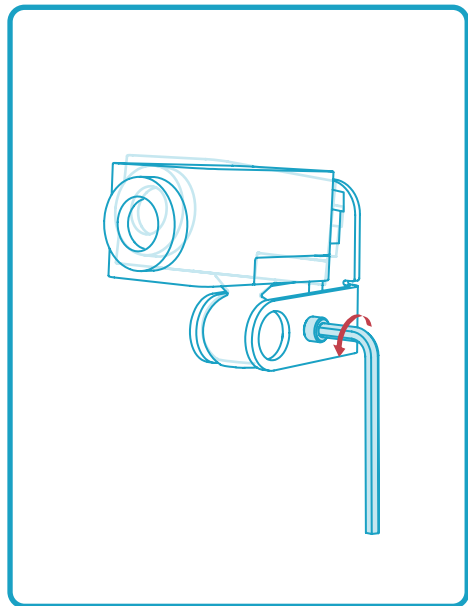

Loosen the screw with the hex key to adjust camera orientation, and then tighten it.

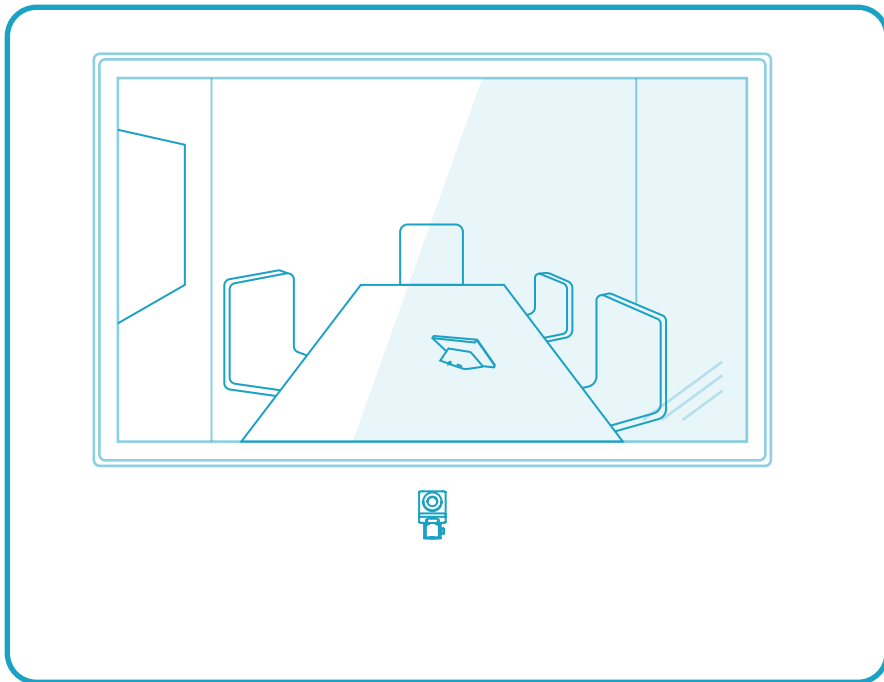

H584 - ADA Camera Mount for Jabra PanaCast

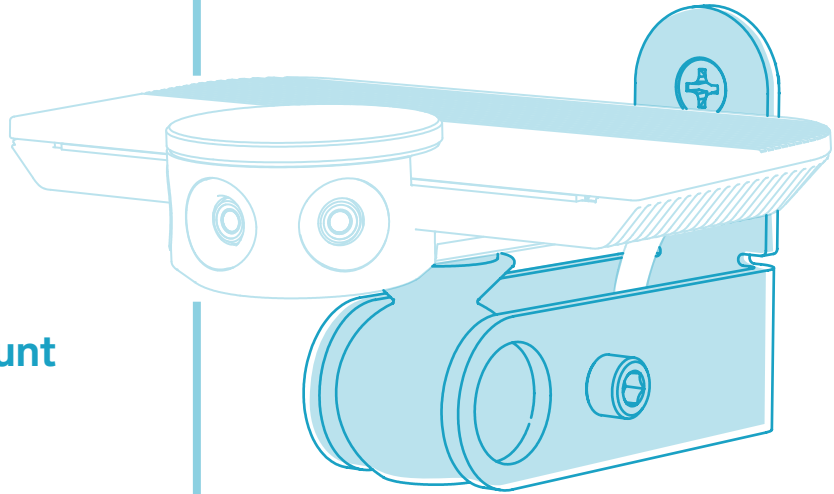

IN THE BOX

- A** 1x ADA Camera Mount
- B** 1x Wall Anchor
- C** 1x Hex Key, 5/32"
- D** 1x Mounting Screw

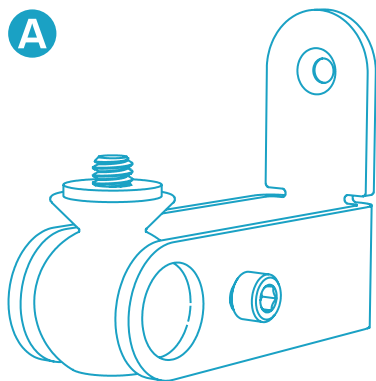

B



C



D



TOOLS NEEDED



Tape Measure



Pen



Power Drill



Phillips
head Bit



1/2" Spade
Drill Bit

COMPONENTS NEEDED (Not Included)



Jabra PanaCast

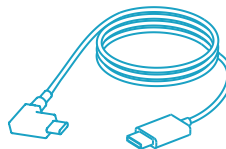

Jabra PanaCast
USB Cable

If you have any questions, please contact
service@hecklerdesign.com.

STEP 1

Locate mounting position

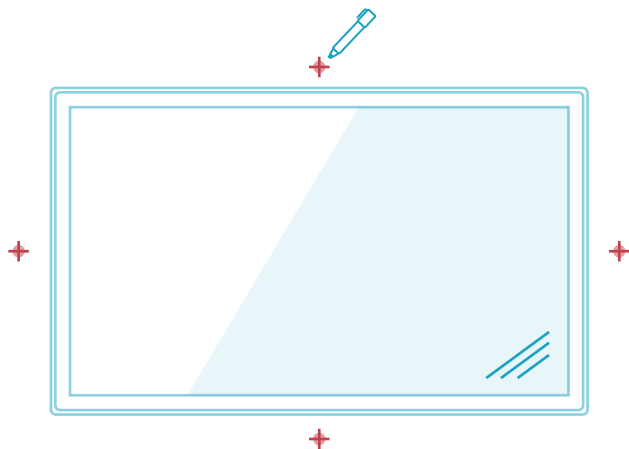

Important Notes:

Locate and mark the ideal location for your ADA Camera Mount. It could be mounted underneath, above or beside the display.

STEP 2

Install the wall anchor

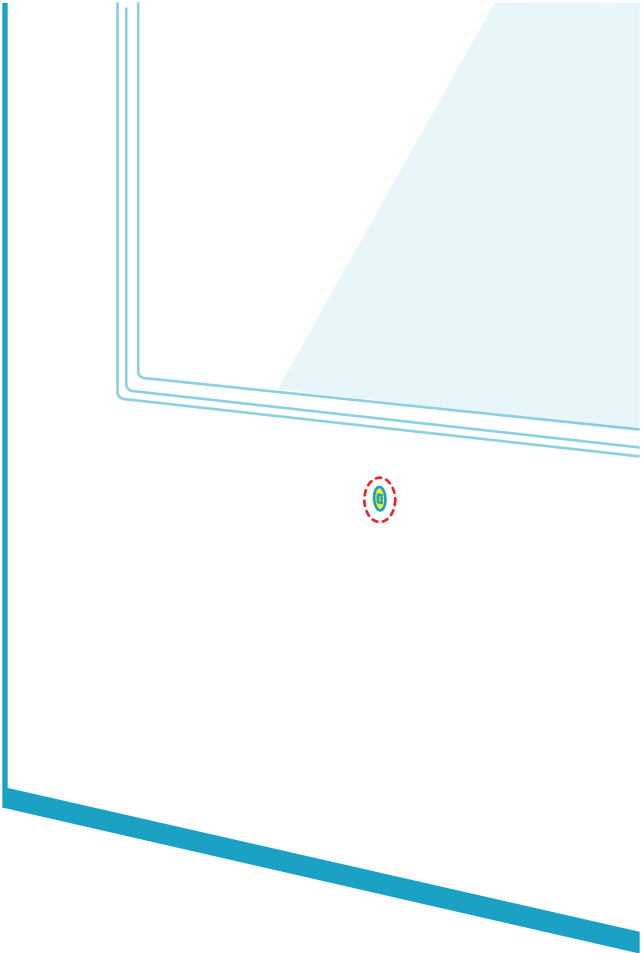
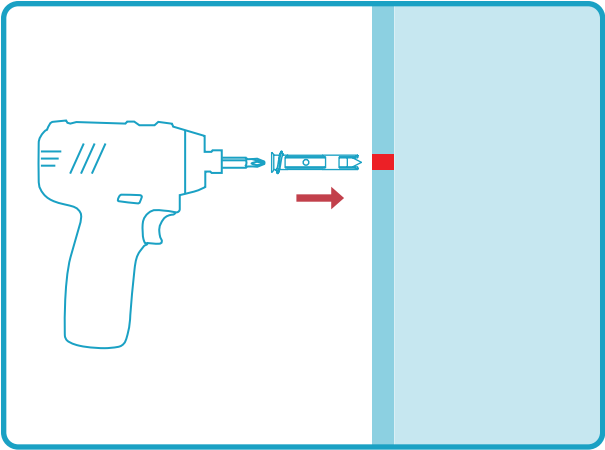

Optional

Mark and drill the hole



Important:

Drill a 1/2-inch hole for the cable to pass through the wall.

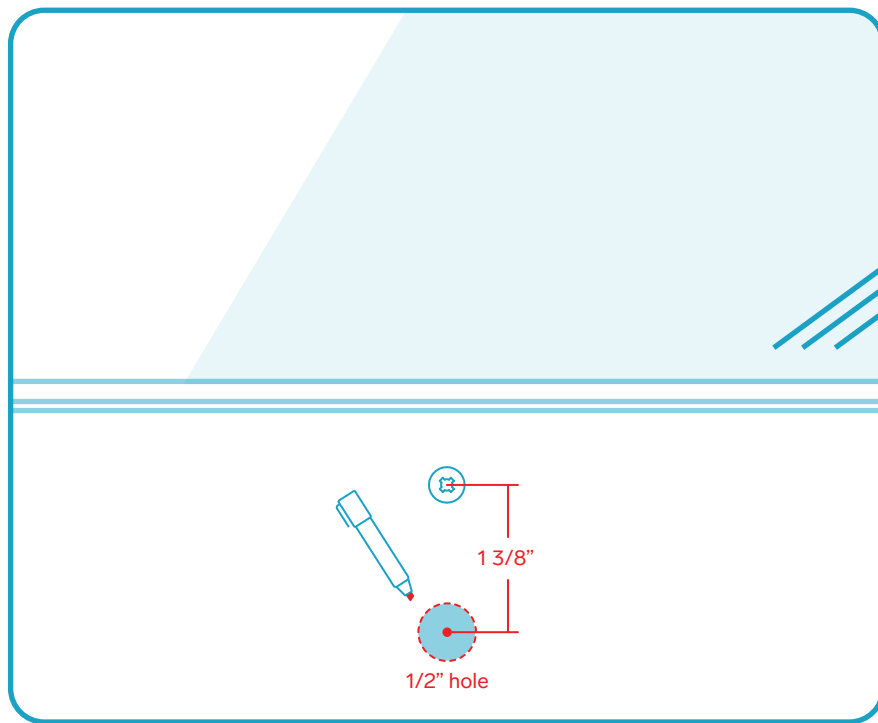

Optional

Route the USB-C cable through the wall

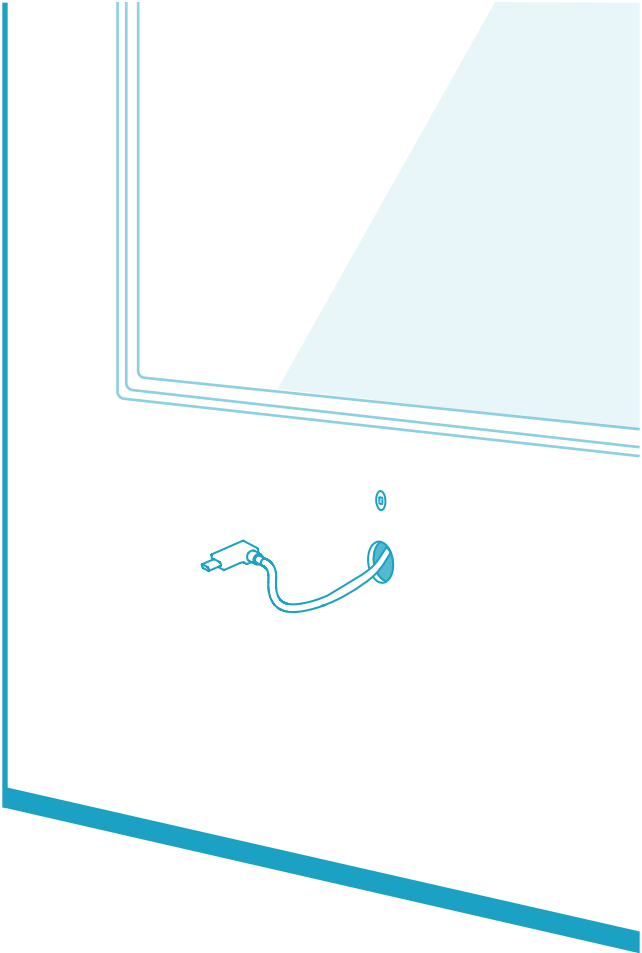
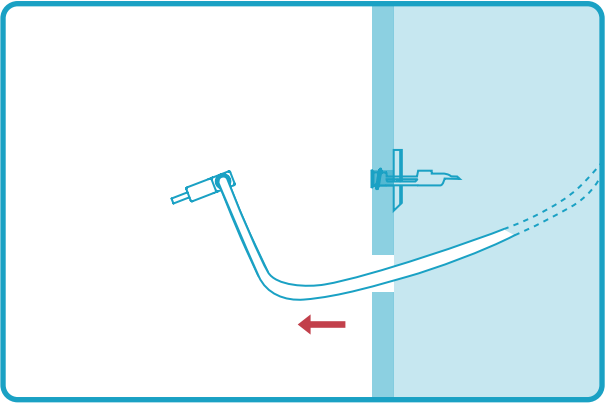

STEP 3

Fasten the ADA Camera Mount

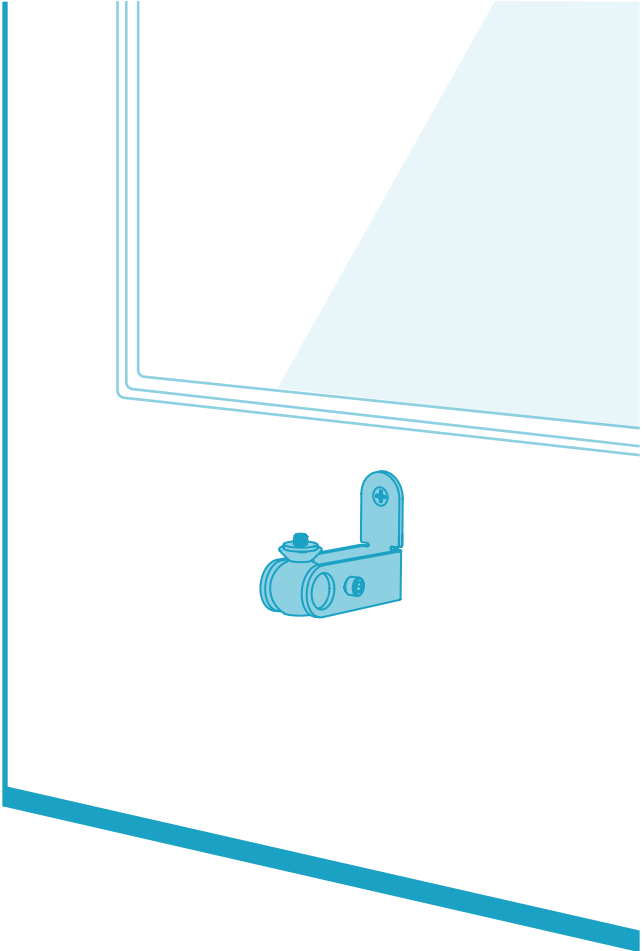
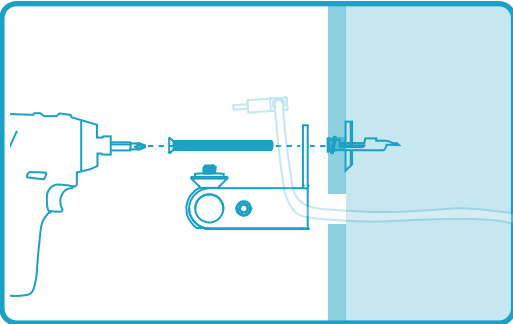

STEP 4

Install the Jabra PanaCast

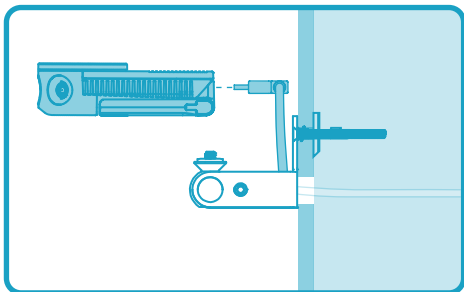

1. Connect the USB-C cable to Jabra PanaCast Camera.

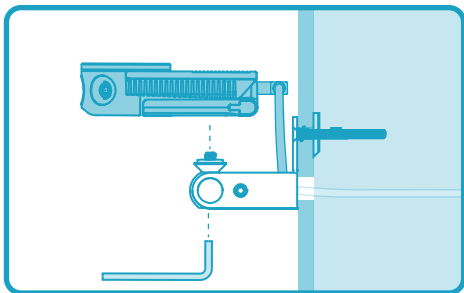

2. Fasten the camera to the ADA Camera Mount with the hex key.

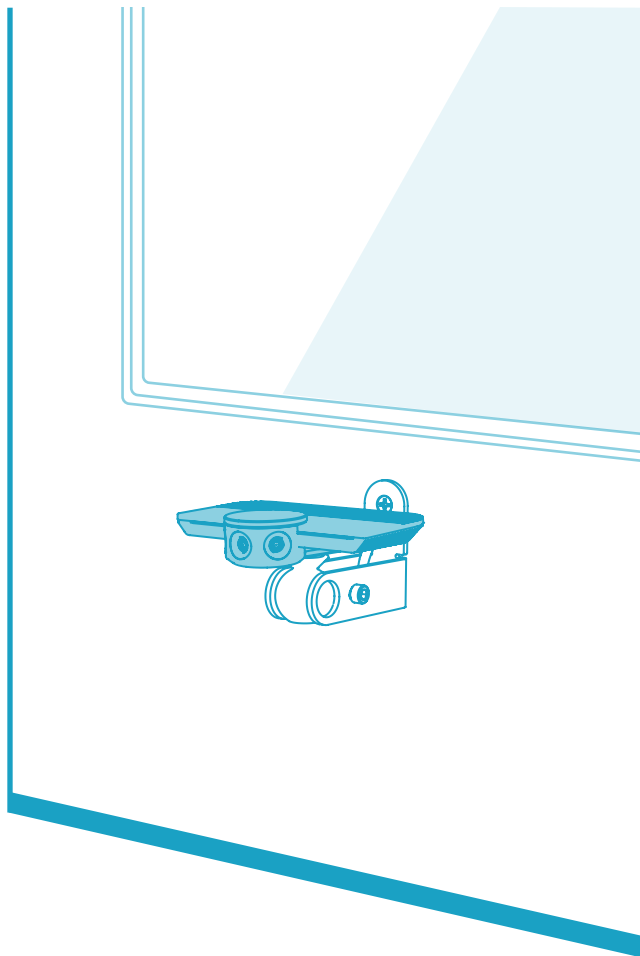

STEP 5

Adjust and set camera orientation.

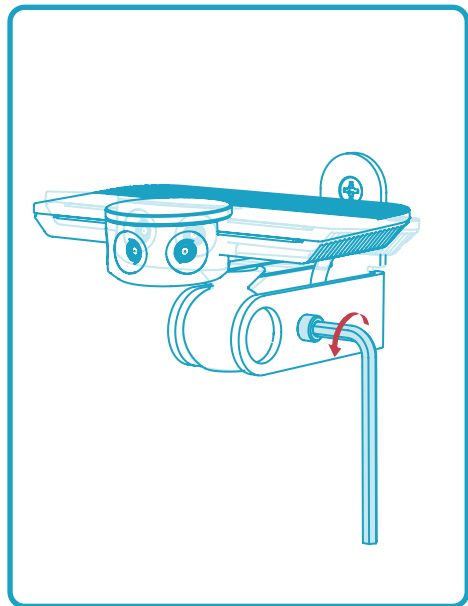

Loosen the screw with the hex key to adjust camera orientation, and then tighten it.

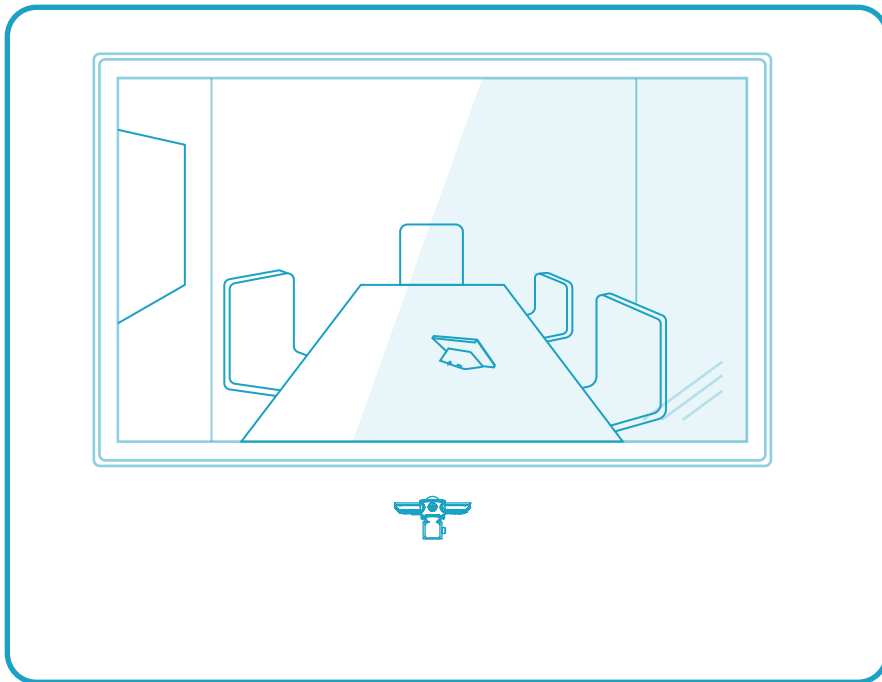

H585 - ADA Camera Mount for AVer CAM340

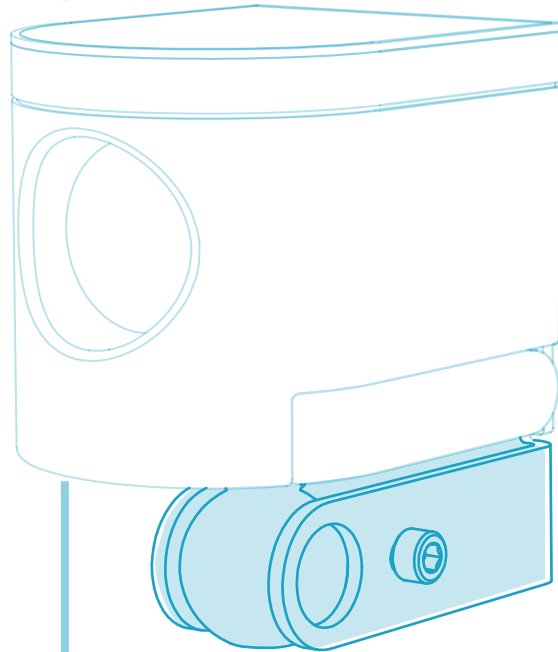

IN THE BOX

- A** 1x ADA Camera Mount
- B** 1x Wall Anchor
- C** 1x Hex Key, 5/32"
- D** 1x Mounting Screw

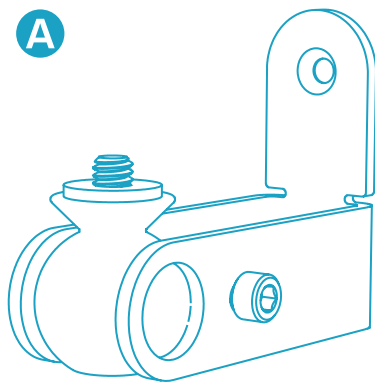

B



C



D



TOOLS NEEDED



Tape Measure



Pen



Power Drill



Phillips
head Bit



1/2" Spade
Drill Bit

COMPONENTS NEEDED (Not Included)

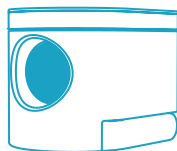

AVer CAM 340

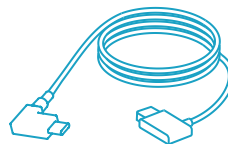

Low-profile USB-C
to USB-A 3.0 cable

If you have any questions, please contact
service@hecklerdesign.com.

STEP 1

Locate mounting position

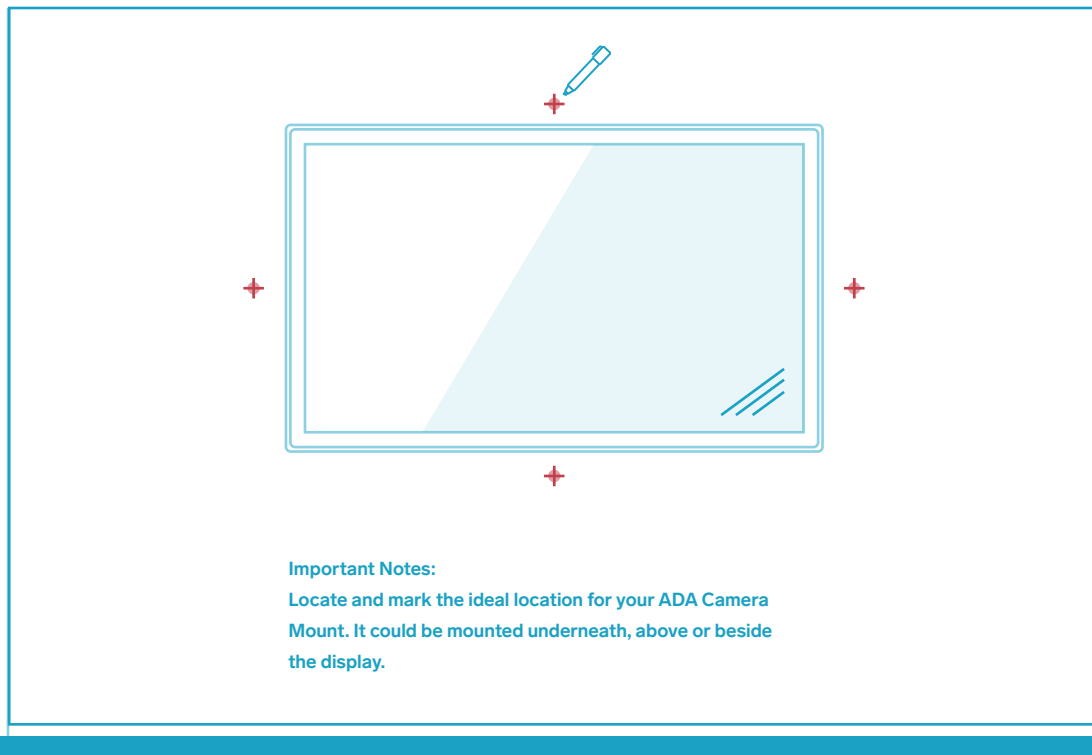

STEP 2

Install the wall anchor

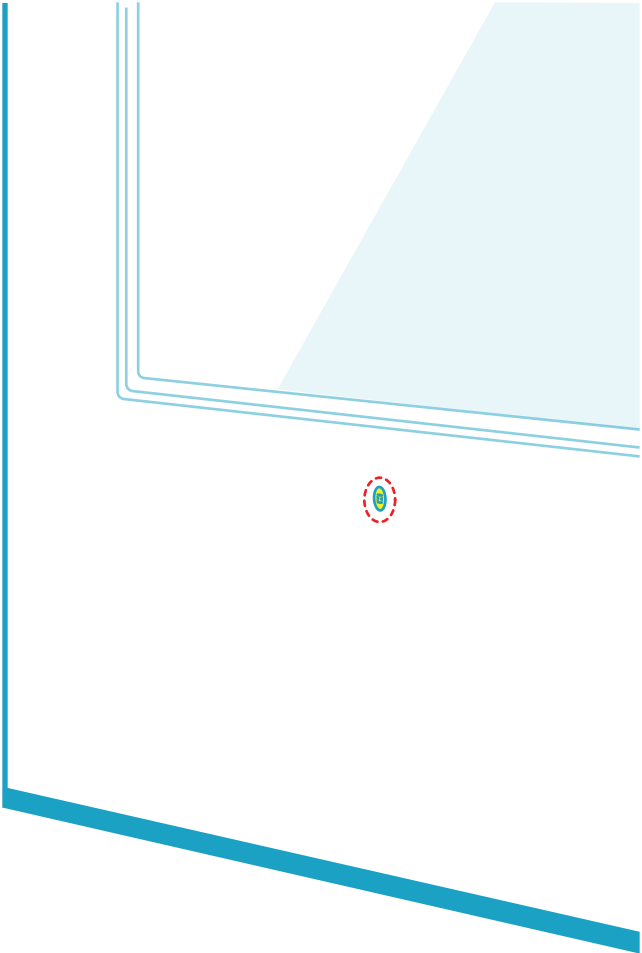
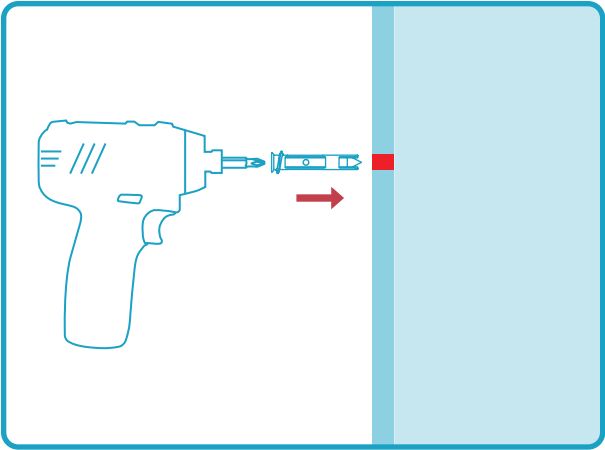

Optional

Mark and drill the hole



Important:

Drill a 1/2-inch hole for the cable to pass through the wall.

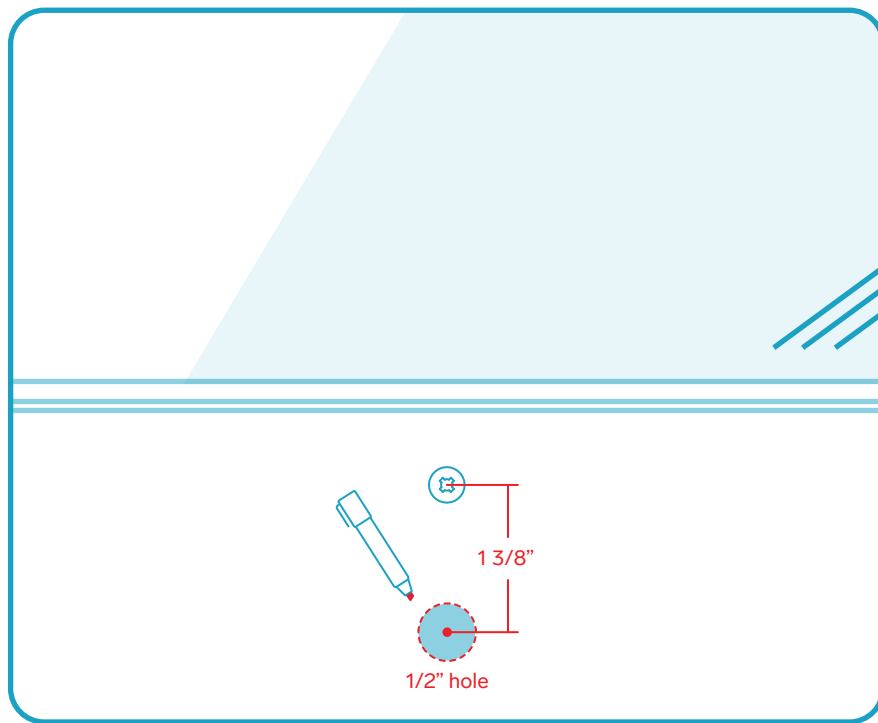

Optional

Route the USB-C cable through the wall

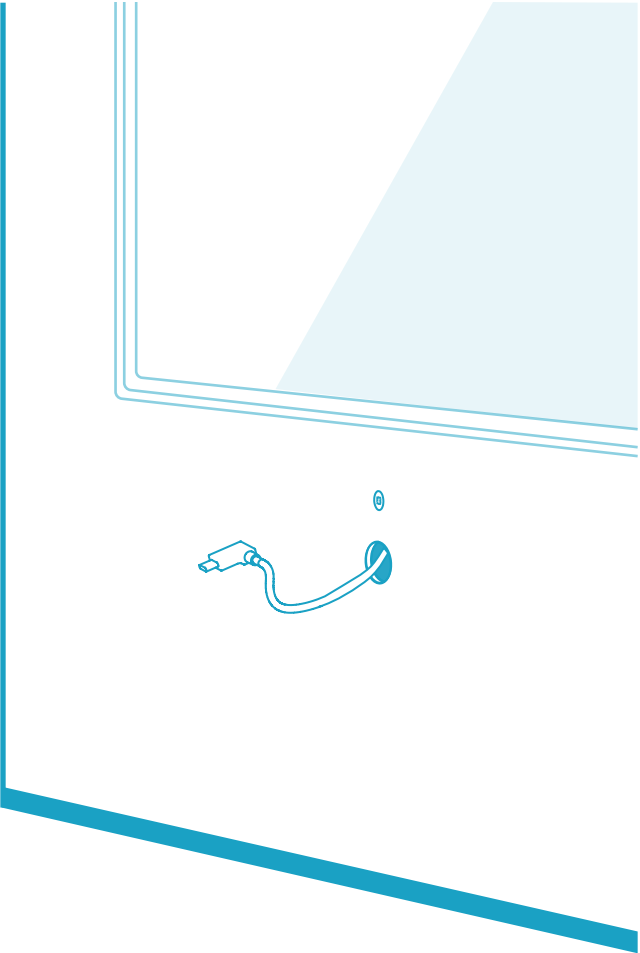
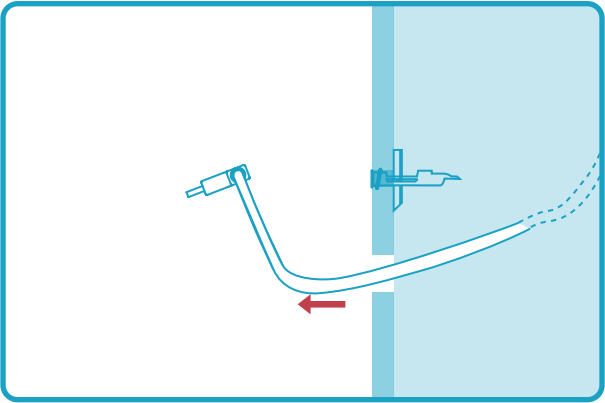

STEP 3

Fasten the ADA Camera Mount

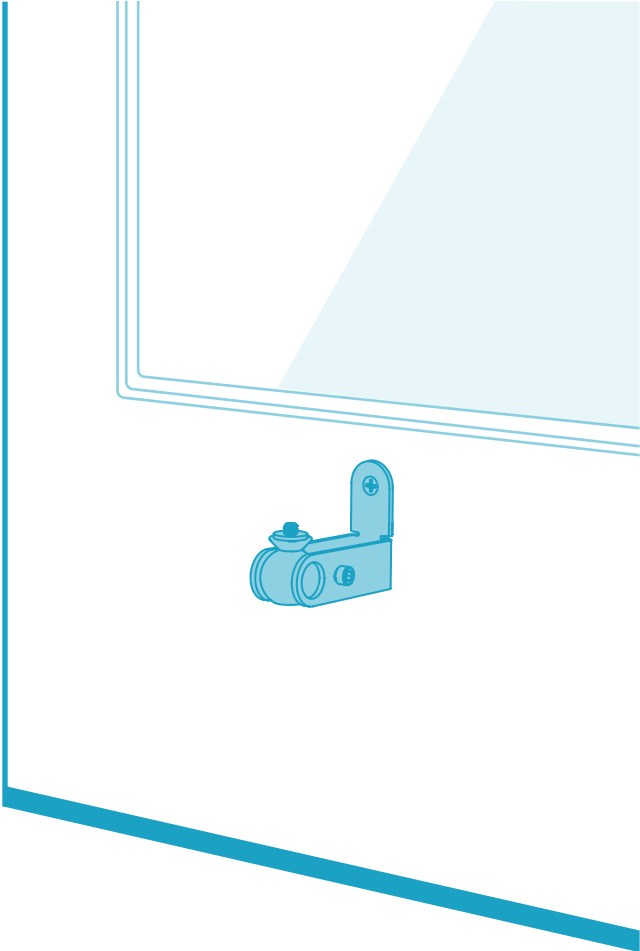
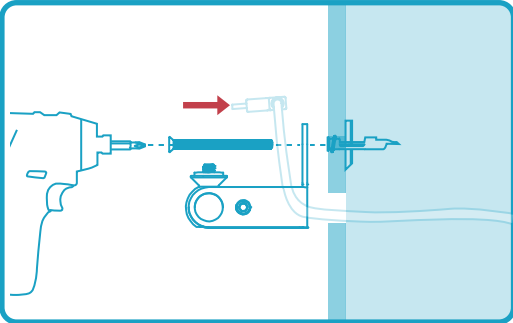

STEP 4

Install the AVer CAM340.

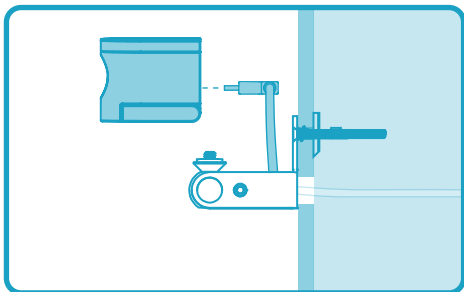

1. Connect the USB-C cable to AVer CAM340 camera.

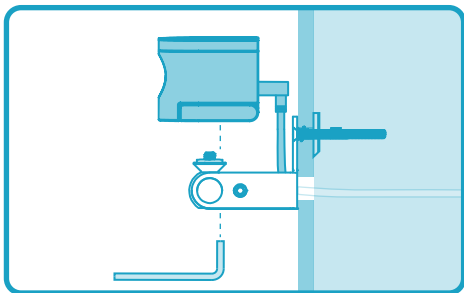

2. Fasten the camera to the ADA Camera Mount with the hex key.

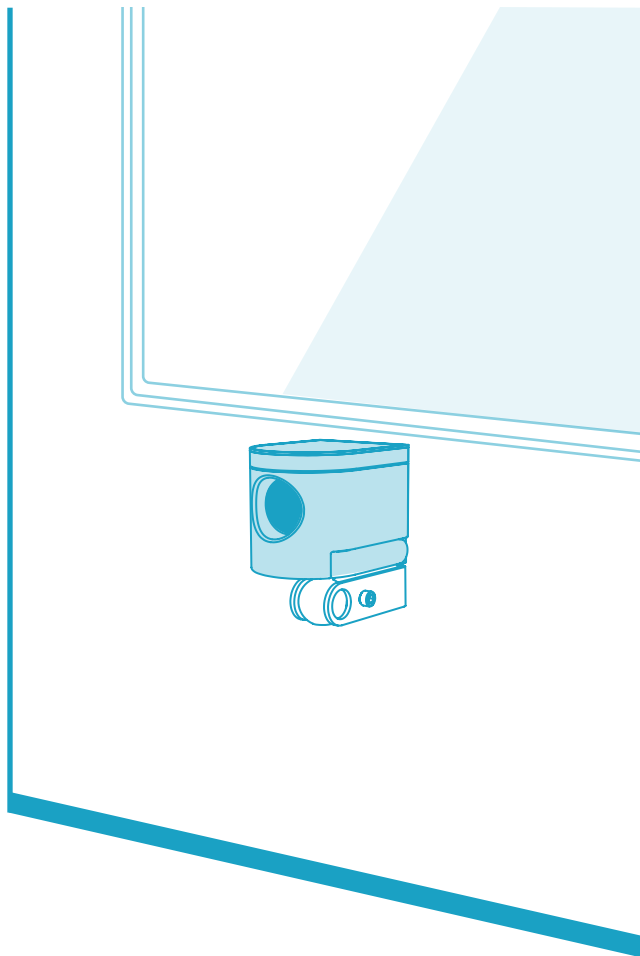

STEP 5

Adjust and set camera orientation.

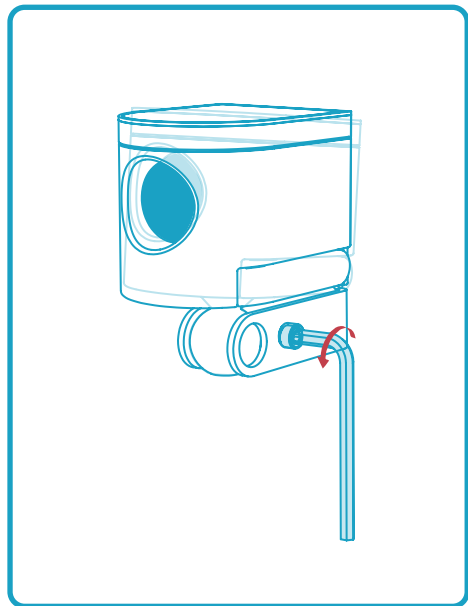

Loosen the screw with the hex key to adjust camera orientation, and then tighten it.

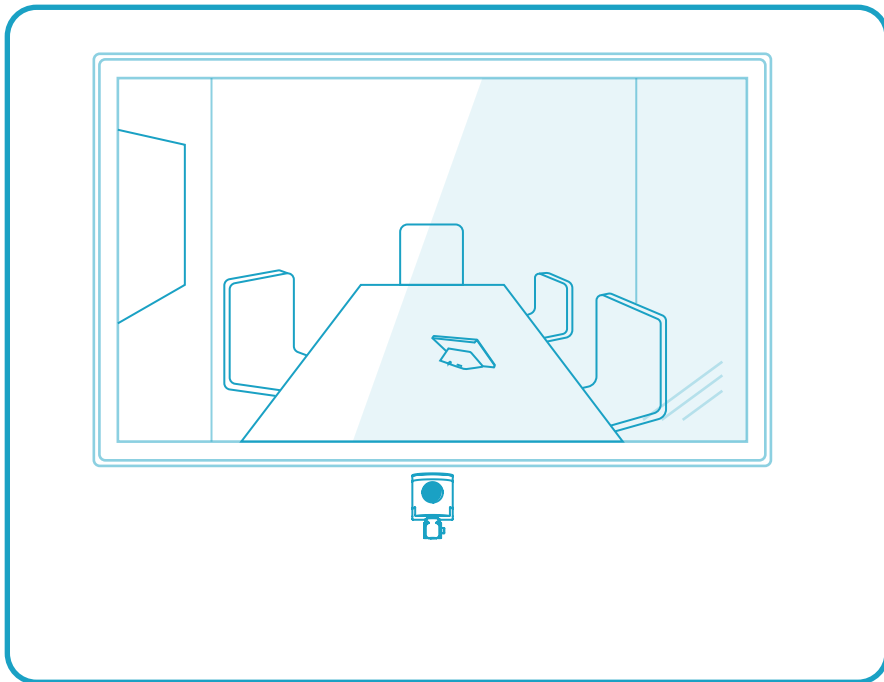

H587 - ADA Camera Mount for Logitech BRIO

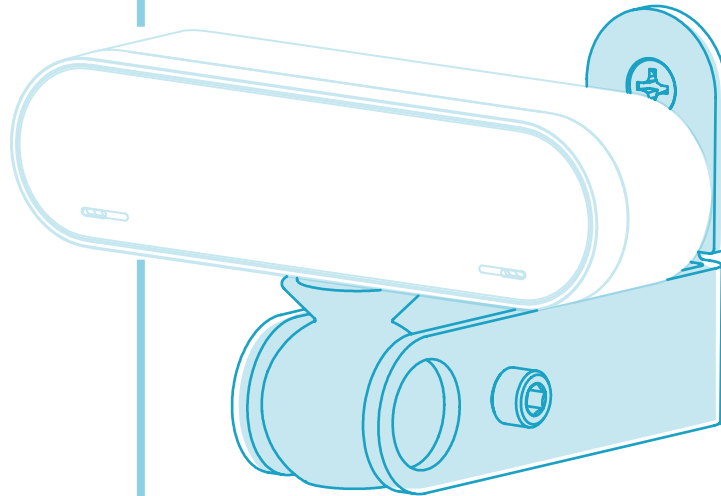

IN THE BOX

- A** 1x ADA Camera Mount
- B** 1x Wall Anchor
- C** 1x Hex Key, 5/32"
- D** 1x Mounting Screw

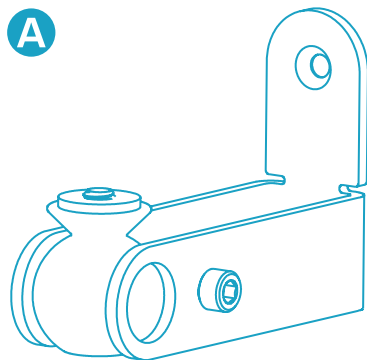

B



C



D



TOOLS NEEDED



Tape Measure



Pen



Power Drill



Phillips
head Bit



1/2" Spade
Drill Bit

COMPONENTS NEEDED (Not Included)



Logitech BRIO

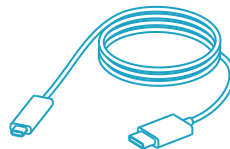

BRIO USB-C Cable

If you have any questions, please contact
service@hecklerdesign.com.

STEP 1

Locate mounting position

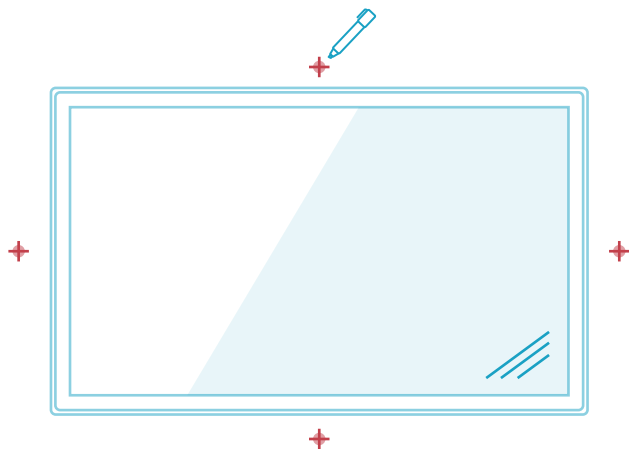

Important Notes:

Locate and mark the ideal location for your ADA Camera Mount. It could be mounted underneath, above or beside the display.

STEP 2

Install the wall anchor

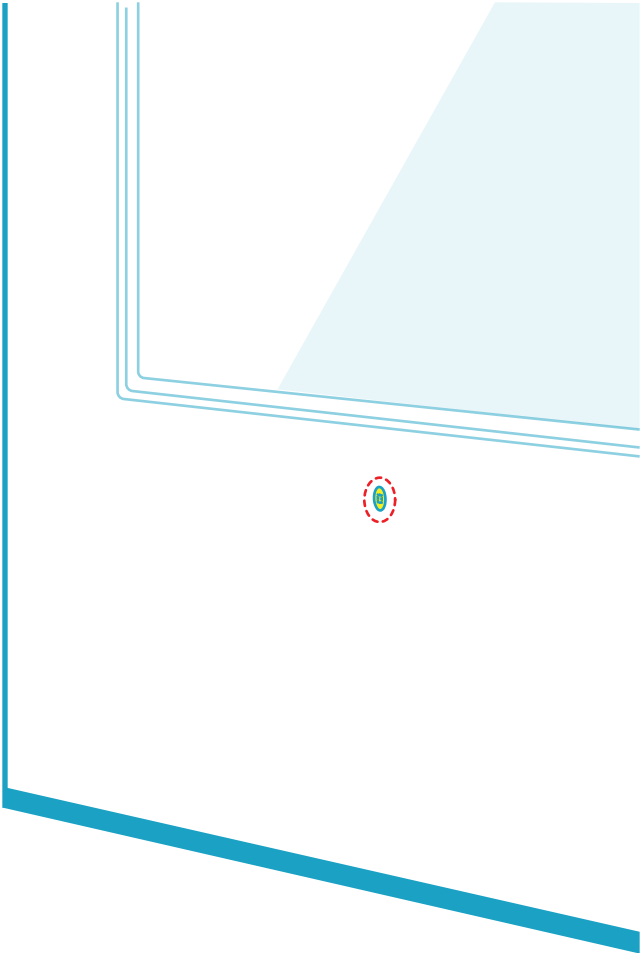
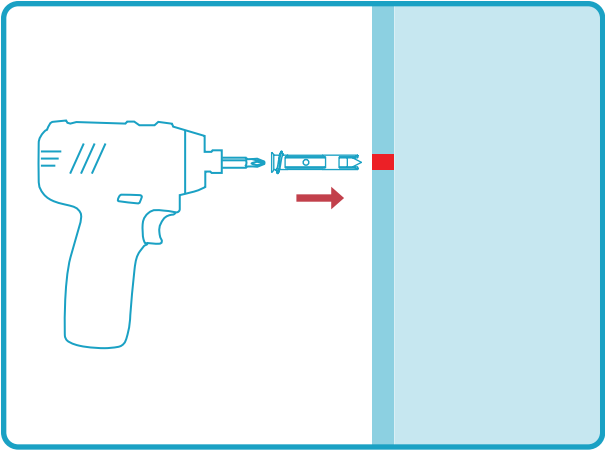

Optional

Mark and drill the hole



Important:

Drill a 1/2-inch hole for the cable to pass through the wall.

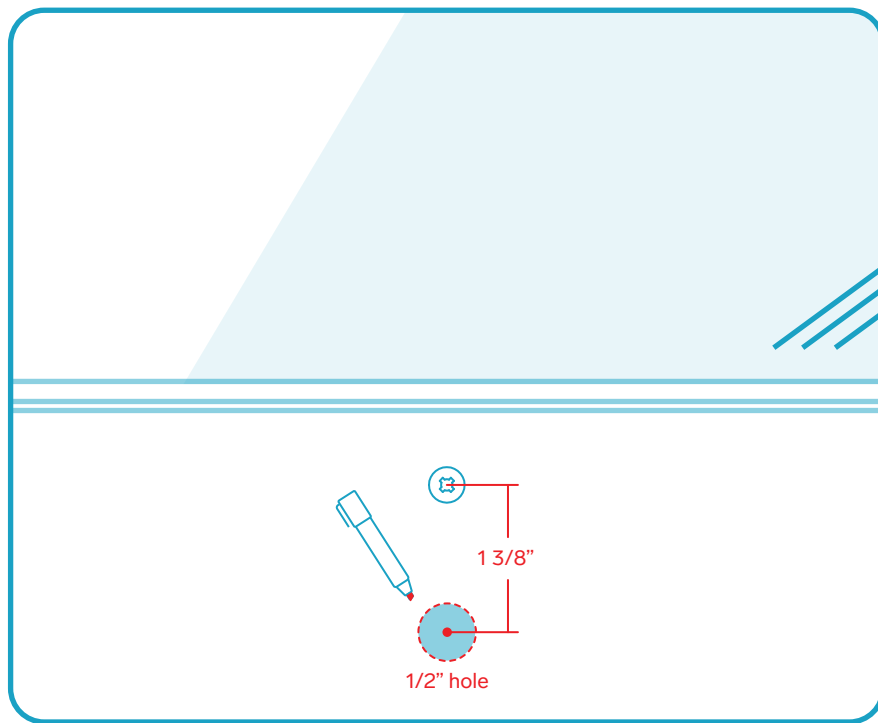

Optional

Route the USB-C cable through the wall

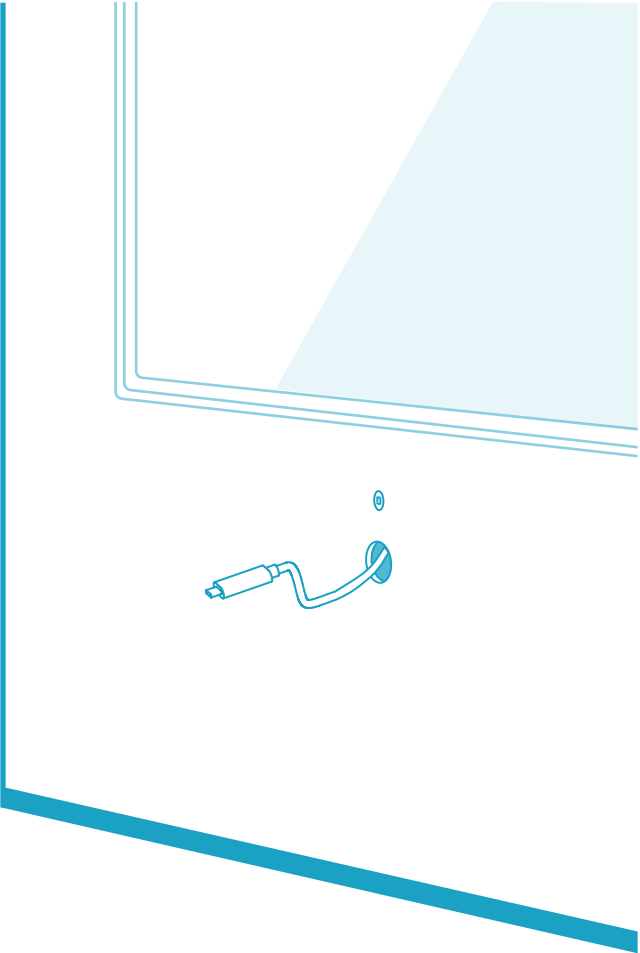
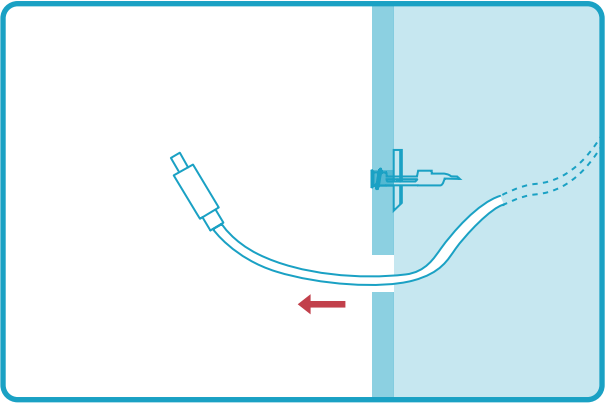

STEP 3

Fasten the ADA Camera Mount

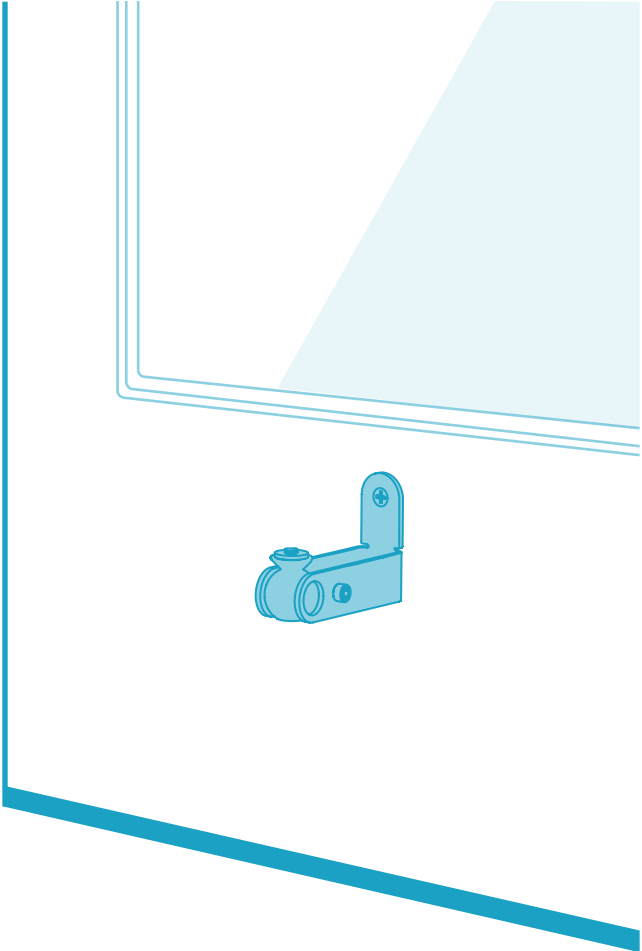
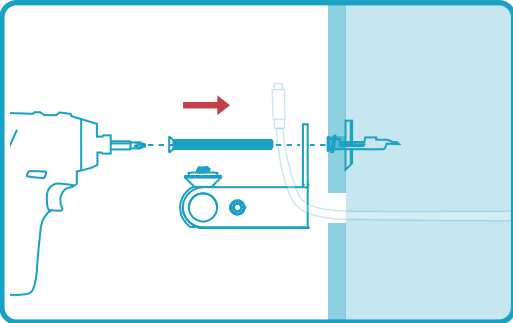

STEP 4

Install the Logitech BRIO

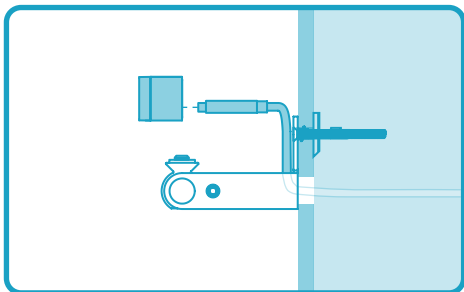

1. Connect the USB-C cable to Logitech BRIO Camera

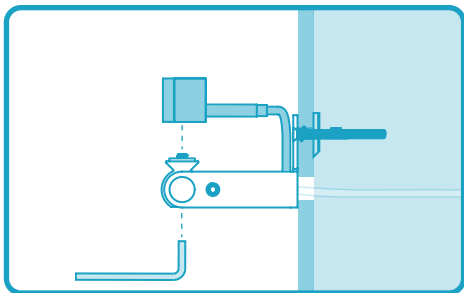

2. Fasten the camera to the ADA Camera Mount with the hex key.

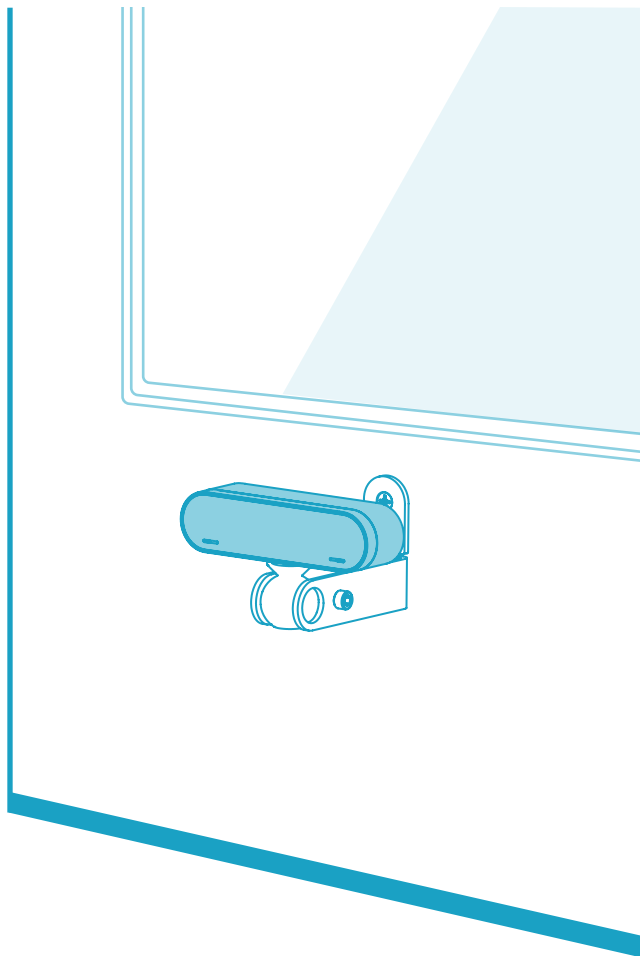

STEP 5

Adjust and set camera orientation.

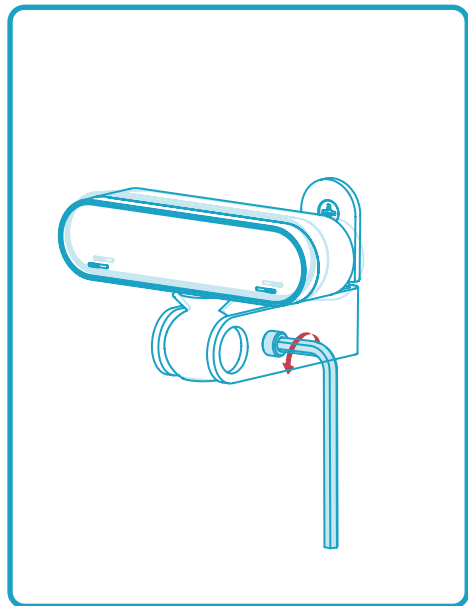

Loosen the screw with the hex key to adjust camera orientation, and then tighten it.

